

TECHNICAL SPECIFICATIONS

This set of photocells with module adopts a control technology that offers high integration and stability. Easy to install, this set has lenses with an excellent quality of focus. It reaches a large transmission distance without interference.

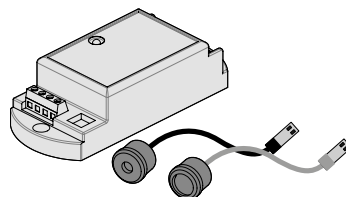

• MODULE DESCRIPTION

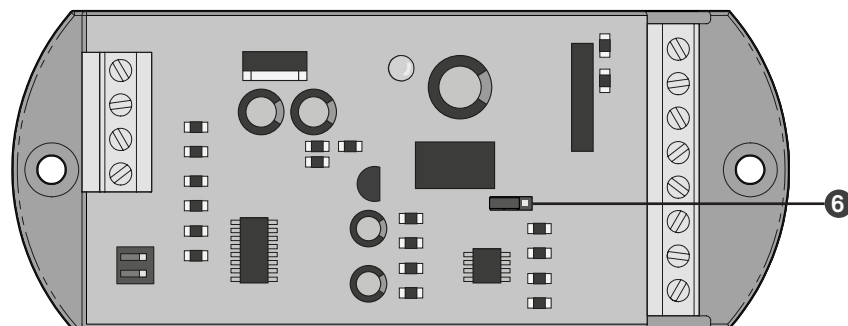
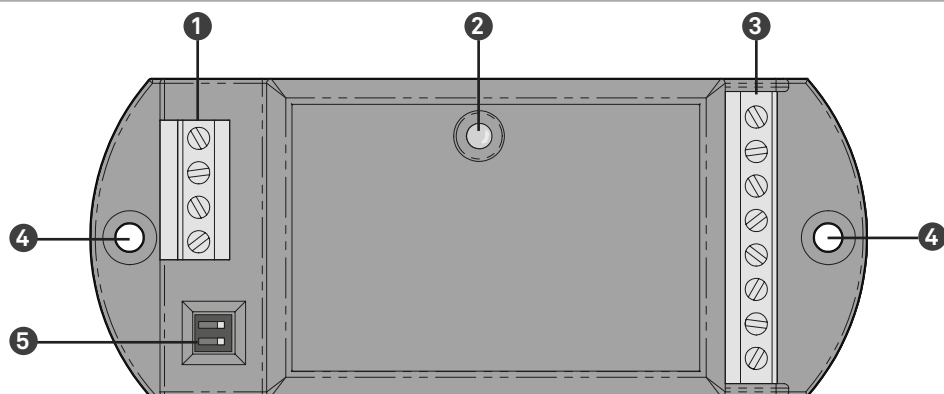

1	Connector with 4 inputs	4	Support plate fixation
2*	Signaling LED	5	Dippers
3	Connector with 8 inputs	6	Jumper

* LEDs behavior:

Red (Fixed) - In Communication | **Green (Fixed)** - Photocell interrupted | **Green (flashing)** - connection error

CHARACTERISTICS BOARD

• Power Supply	AC/DC 12 to 30V (-/+10%)
• "Stand-by" consumption	12V-35mA
• Operation Consumption	12V-72mA
• Maximum distance between photocells	7m
• Radius	Single or Double Ray
• Working temperature	-42°C to 45°C
• Operating Humidity	10% to 90% RH
• Dimensions (module)	123 x 50 x 32mm
• Dimensions (photocell's head)	19 x 13 mm
• Weight	1 set - 235gr

• DIPPERS

	ON	
Close distances	<input checked="" type="checkbox"/> 2	Long distances
2 sets of photocells	<input type="checkbox"/> 1	1 set of photocells

• JUMPER (SELEC. SAÍDA)

<input checked="" type="checkbox"/> NC	<input type="checkbox"/> NO
--	-----------------------------

INSTALLATION

• MODULE

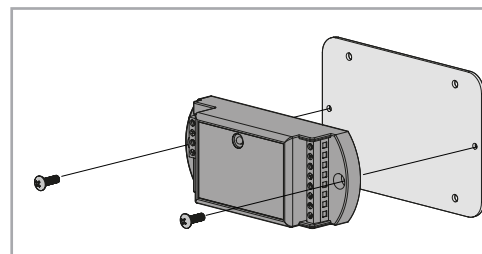

01. Secure the module on the plate.

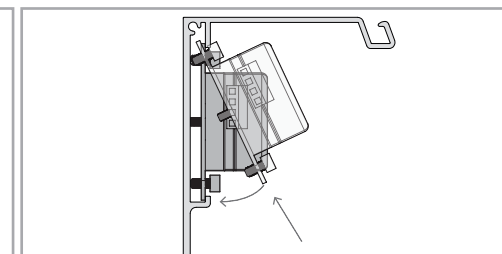

02. Place the plate on the door, first engaging the top and then the bottom limits of the plate.

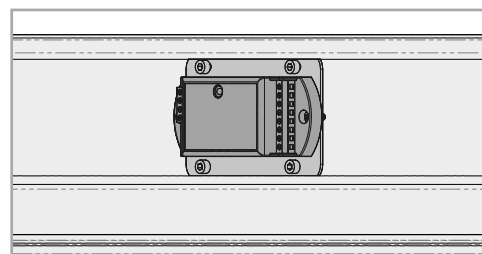

03. Tighten the existing screws in the plate corners in order to create pressure between the module plate and the door profile.

INSTALLATION

• PHOTOCELLS

The photocells height should be selected according to the amount of kits:

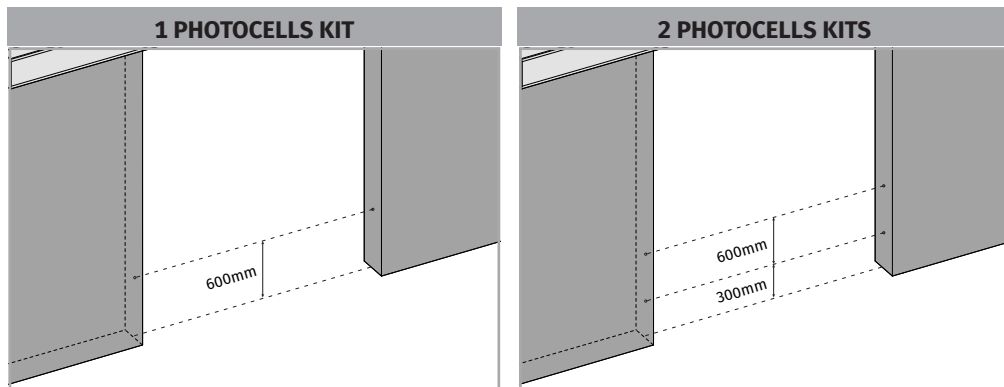

01. Measure and mark the drilling holes on the pillars or in the passage's aluminum plates. Note that for proper function, the photocells must be aligned horizontally.

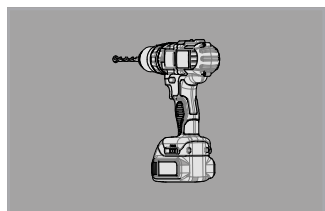

02. On the places that you chose, make the holes with 13mm radius and with a depth of 30mm.

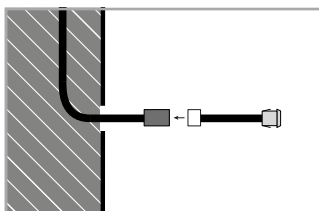

03. Pass the cable of each photocell through the interior of pillar or aluminum plate, to reach the module in the door's safe.

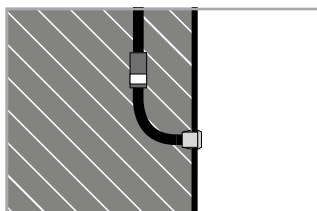

04. Place the photocells in the drillings holes.

CONNECTIONS SCHEME



CONNECTIONS SCHEME

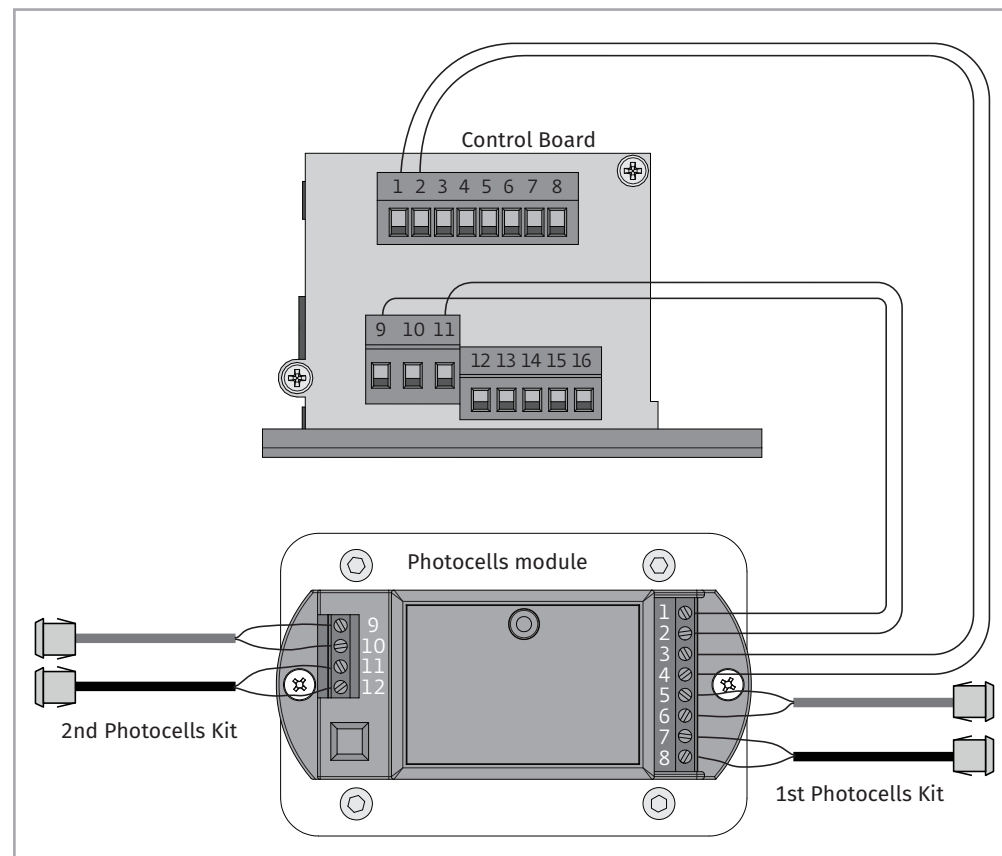

Nº1	→	Nº9 Control board	Nº7	→	Photocell 1 - Black
Nº2	→	Nº11 Control board	Nº8	→	Photocell 1 - Black
Nº3	→	Nº1 Control board	Nº9	→	Photocell 2 - Blue
Nº4	→	Nº2 Control board	Nº10	→	Photocell 2 - Blue
Nº5	→	Photocell 1 - Blue	Nº11	→	Photocell 2 - Black
Nº6	→	Photocell 1 - Blue	Nº12	→	Photocell 2 - Black



If you install only one photocell kit, you should always connect it on the inputs 5,6,7 and 8.